



Installation Instructions Performer® Cuspidor (For Performer III Chair & International Performer I Chair)

You Will Need

- Adjustable wrench or 9/16" open-end wrench
- Magnetic leveling device
- 3/16" hex key
- Torque wrench (preferred)

About This Install

This installation instruction is for installing a Performer cuspidor on a Performer I or Performer III chair.

Before Beginning

Check with local and state code authorities about installation requirements for this product.

Before installing the Performer cuspidor:

- Prepare the plumbing
- Install the chair
- Raise the chair to full base up

Preparing the plumbing

If the air and water manual shutoff valves have not already been installed, do so now. Refer to the floor box installation instruction, A-dec Publication No. 85.2802.00.

Purge the air and water supplies of debris.

Installing the chair

If a Performer chair is not already installed, install it now. Refer to the instructions that came with the chair. Do not install the chair upholstery until all installations are complete.

NOTE: If a Performer delivery system is being installed, install it according to its instructions, before adding the cuspidor to the chair.

Raising the chair to full base up

For Performer III instructions go to *Raising the chair to full base up for Performer III* on page 2.

Full base up for Performer I

Move the joystick control up toward the chair for full base up position (see *Performer I*).

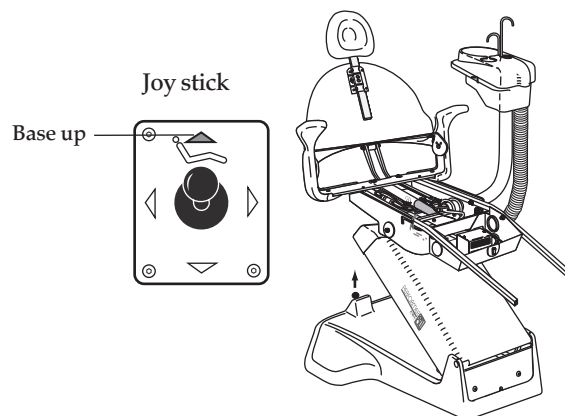

NOTE: If you're installing the cuspidor to a Performer I chair go to *Installing a Performer Cuspidor to Performer I Chair (International only)* on page 3.

Raising the chair to full base up for PerformerIII

Press the base up button on the footswitch or touchpad (see *Performer III*).

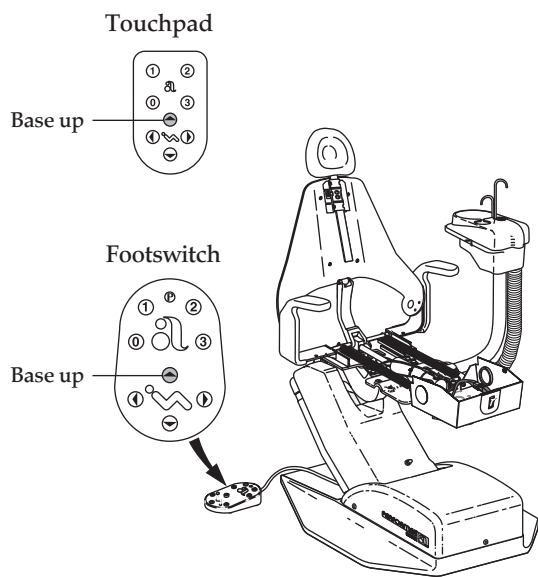

Performer III

NOTE: If you're installing the cuspidor to a Performer III chair go to *Installing a Performer Cuspidor to Performer III Chair* on page 5.

Installing a Performer Cuspidor to Performer I Chair (International only)

Mounting and leveling the cuspidor

1. Install one o-ring onto each end of the U-bolts.
2. Insert the U-bolts down through the chair structure.
3. Loosely install a washer, a split washer, and a hex nut onto each end of the U-bolt (see *Installing cuspidor to Performer I chair*).
4. Insert the cuspidor post through the U-bolts and begin tightening the hex nuts until snug.

CAUTION

The U-bolts may become damaged if the nut is tightened past 25 ft lb (34 N m), or if both nuts on the U-bolt are over tightened.

5. Level the cuspidor post, then fully tighten the hex nuts.

Installing the cuspidor

- Install the cuspidor onto the cuspidor post.
- Install the cup fill spout (long) and the bowl rinse spout (short) on the cuspidor.

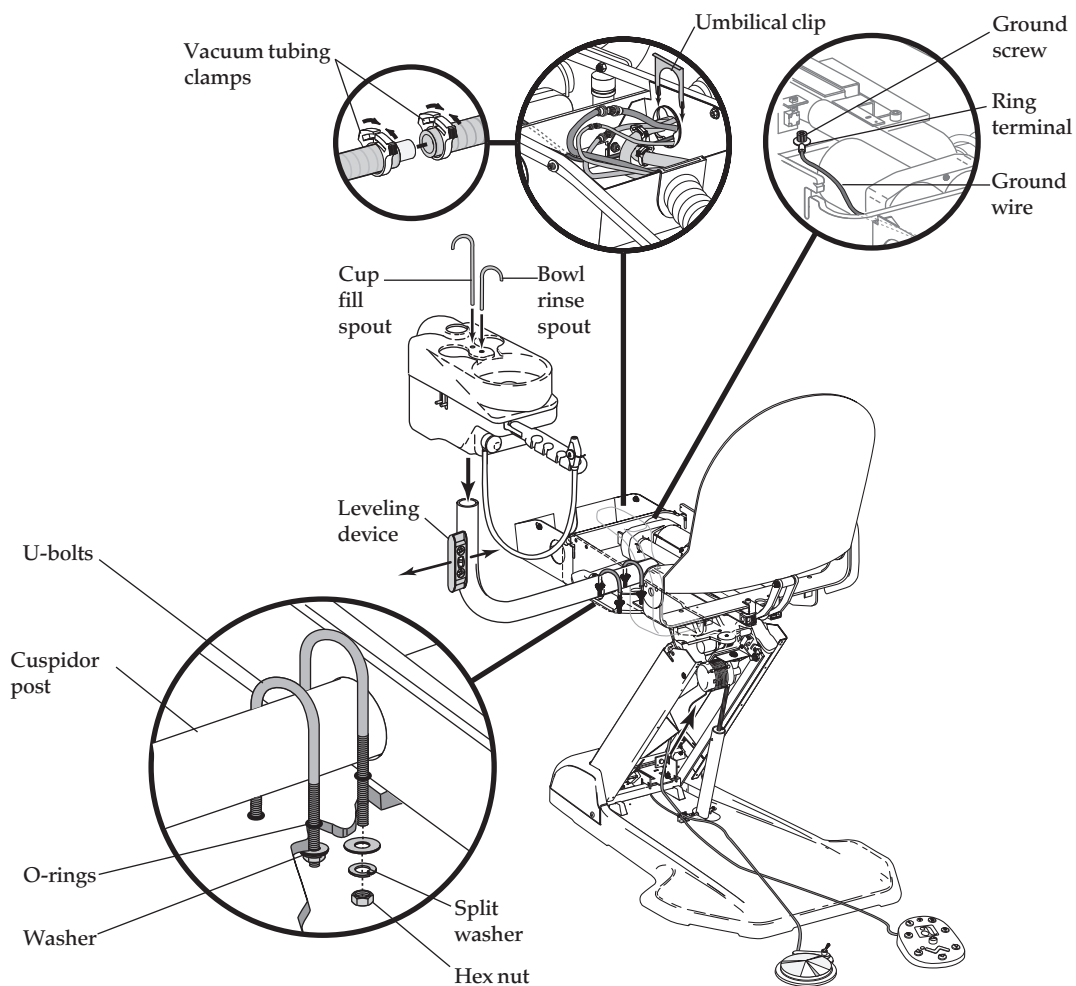

Installing cuspidor to Performer I chair

Installing the junction box

1. Route the cuspidor umbilical into the junction box. Secure it using the umbilical clip (see *Installing a cuspidor to Performer I chair* on page 3).
2. Matching tubing color and dash pattern, connect the tubing in the junction box.
3. Locate and remove the ground screw from the chair (see *Installing a cuspidor to Performer I chair* on page 3).
4. Insert the ground screw through the ring terminal and reinstall the ground screw to the chair.
5. Install the ground wire's ring terminal to the ground screw and reinstall the ground screw.

Go to *Testing the Cuspidor* on page 6.

Installing a Performer Cuspidor to Performer III Chair

Mounting the cuspidor

1. Insert the U-bolts up through the chair structure and loosely install a washer, split washer, and hex nut onto each end of the U-bolt (see *Installing a Cuspidor to the Performer III Chair*).
2. With the chair in the down position, disconnect the back-down spring on the appropriate side. Install the 3/8" adjusting screw.
3. Insert the cuspidor post through the U-bolts and begin tightening the hex nuts until snug.

Leveling the cuspidor post

1. Use the adjusting screw for side to side leveling of the cuspidor post.

CAUTION

The U-bolts may become damaged if the nut is tightened past 25 ft lb (34 N·m), or if both nuts on the U-bolt are over tightened.

2. Tighten both nuts on each U-bolt snugly. (Tighten one of the nuts on each U-bolt to 25 ft lb [34 N·m] maximum or an additional 1/2 turn clockwise).
3. Check the leveling of the post.
4. Reattach the back-down spring.
5. Install the cuspidor onto the cuspidor post.
6. Install the cup fill spout (long) and the bowl rinse spout (short) on the cuspidor.

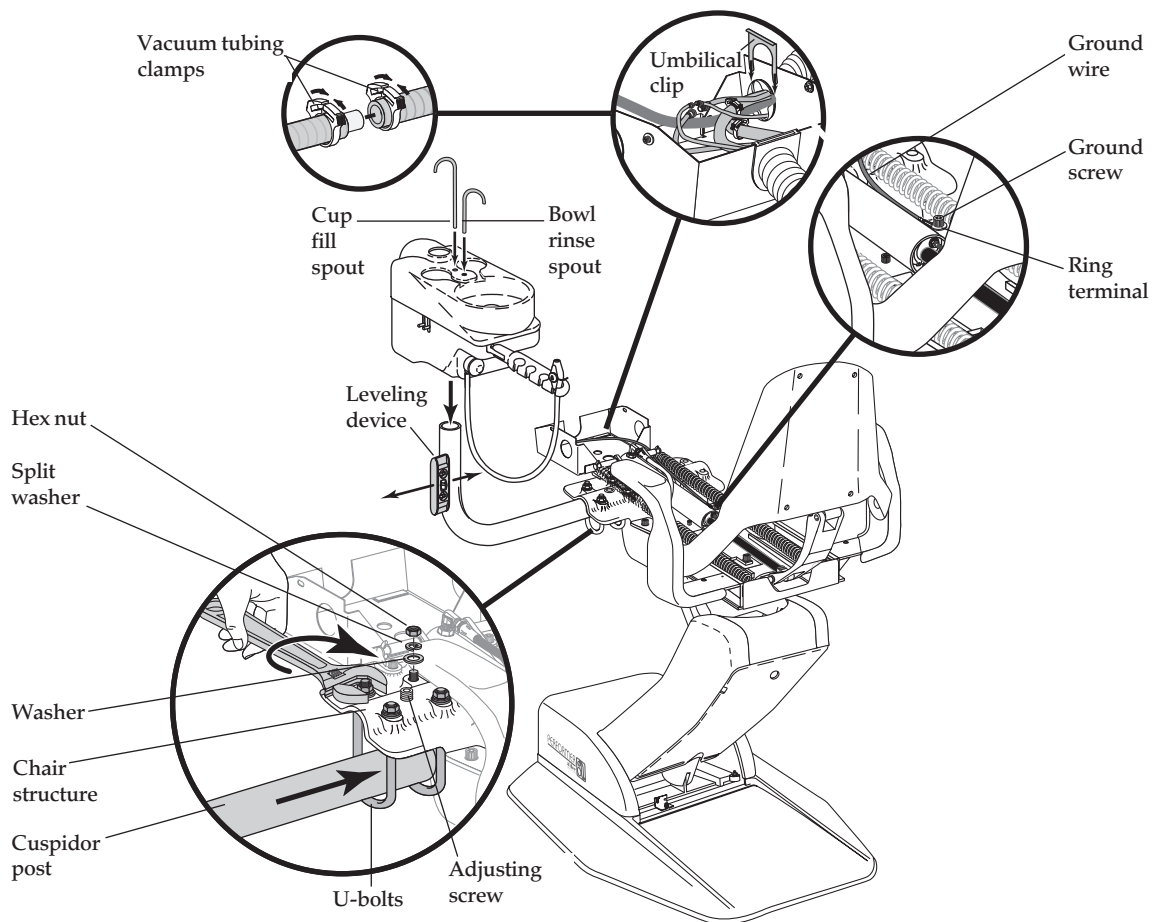

Installing a cuspidor to the Performer III chair

Installing the junction box

1. Route the cuspidor umbilical into the junction box. Secure it using the umbilical clip (see *Installing a cuspidor to Performer III chair* on page 5).
2. Matching tubing color and dash pattern, connect and secure the tubing in the junction box.
3. Locate and remove the ground screw from the chair (see *Installing a cuspidor to Performer III chair* on page 5)
4. Route the ground wire (green/yellow) from the cuspidor umbilical to the ground screw location.
5. Install the ground wire's ring terminal to the ground screw and reinstall the ground screw.

Testing

Testing the cuspidor

1. Fill and install the water bottle. Refer to the *Self-contained Water Bottle* installation instructions.
2. If a self-contained water bottle is present, remove it. Fill it with water specified by the dental staff and reinstall.

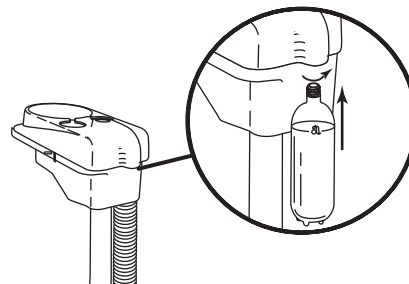

Installing a Filled Water Bottle

3. Turn On the vacuum. Fully open the manual air and water supplies in the floor box.

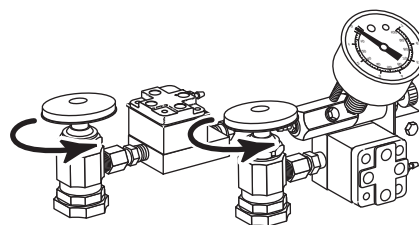

Opening the manual air/water supplies

4. Turn the unit ON at the floor box.

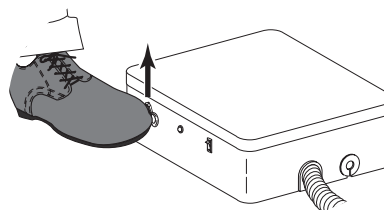

Turning On the unit

Testing the HVE and Saliva Ejector

1. Test the HVE and saliva ejector.
2. Place a cup under the cup fill spout. Press and hold the cup fill activation rod. It will take several seconds before the water flows uninterrupted.

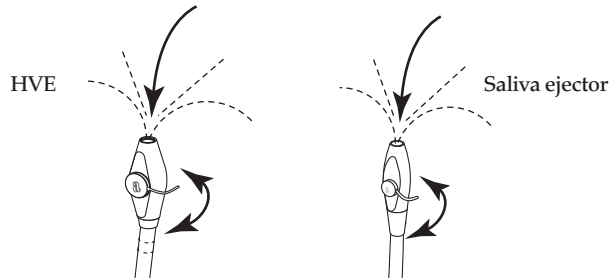

Testing the HVE and Saliva Ejector

3. Make sure the bowl rinse spout is directed over the bowl. Press and hold the bowl rinse activation rod. Make sure water flows uninterrupted to the bowl without splashing.

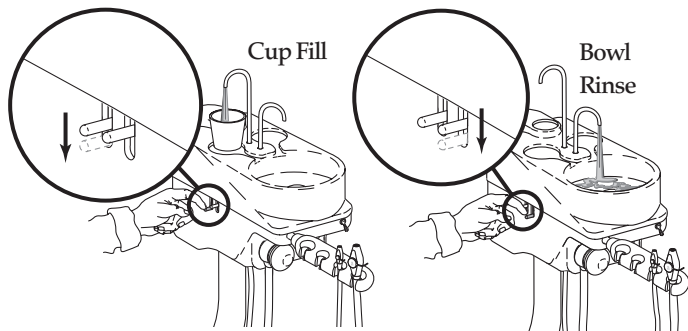

Cup fill and bowl rinse activation

Adjusting the Bowl Rinse Water Flow

In the floor box, locate the pinch clamp on the blue with white dashes tubing.

- To decrease water flow, tighten the pinch clamp.
- To increase water flow, loosen the pinch clamp.

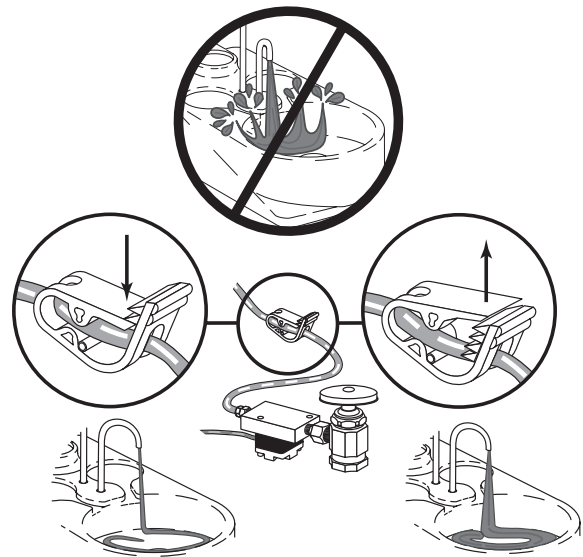











Bowl rinse adjustment

Before Leaving the Facility

1. Check all plumbing connections for leakage.
2. Install all covers.
3. Distribute the Owner's Guide(s) and instruct the dental team in the operation and maintenance of the equipment.

Identification of Symbols

SYMBOL	DESCRIPTION
	Recognized by Underwriters Laboratories Inc. with respect to electric shock, fire and mechanical hazards only in accordance with UL 60601-1 (2601-1) and under mutual recognition agreement with CAN/CSA C22.2, No. 601.1.
	Classified by Underwriters Laboratories Inc. with respect to electric shock, fire and mechanical hazards only in accordance with UL 60601-1 (2601-1) and under mutual recognition agreement with CAN/CSA C22.2, No. 601.1.
	UL listed to UL 61010A-1, BS EN 61010-2-010 and Canadian (CAN/CSA C22.2, No. 1010.1-92) safety standards.
	Conforms to applicable European Directives (refer to Declaration of Conformity).
	Protective earth (ground).
	Functional earth (ground).
	Attention, consult accompanying documents. No user serviceable parts. Attention, line voltage. Only licensed electrician should remove cover.
	Type B applied part.
	Class II equipment.
	Caution: Metal surfaces can be hot during and following the dry cycle.

Electrical Rating

TYPE	SPECIFICATION
Volts:	100/110-120/220-240 VAC
Frequency:	50-60 Hz
Current:	As configured and specified in equipment manual (products labeled 15A or greater require dedicated circuit, identified in distribution panel).

Classification of Equipment (EN-60601-1)

TYPES/MODE	CLASSIFICATION
Types of shock protection	CLASS I EQUIPMENT: Dental chairs, dental lights, and power supplies CLASS II EQUIPMENT: Chair, wall, and cart-mounted delivery systems
Degree of shock protection	TYPE B APPLIED PART: Delivery systems only
Degree of protection against water ingress	ORDINARY EQUIPMENT: All products
Mode of operation	CONTINUOUS OPERATION: All models except dental chairs CONTINUOUS OPERATION WITH INTERMITTENT LOADING: Dental chairs - 5% duty cycle
Flammable gasses:	Not suitable for use in the presence of a flammable anesthetic mixture with air, oxygen, or nitrous oxide, where such gasses may accumulate in concentration (closed space).

Environmental Specifications

TEMPERATURE/HUMIDITY	SPECIFICATION
Storage/Transportation	Temperature: -40C to 70°C (-40°F to 158°F) Relative humidity: 80% for up to 31°C, decreasing linearly to 50% at 40°C.
Operating	Temperature: 10°C to 40°C (40°F to 104°F) Relative humidity: 80% for up to 31°C, decreasing linearly to 50% at 40°C.
Indoor Use:	Altitude up to 2,000M (6,563 ft.), installation category II, pollution degree 2. (UL 61010A-1 and CAN/CSA C22.2, No. 1010.1-92 only)

A-dec Inc.

2601 Crestview Drive
Newberg, OR 97132 USA
Tel: 1-800-547-1883
within USA/Canada
Tel: 1-503-538-7478
outside USA/Canada
www.a-dec.biz

A-dec United Kingdom

A-dec United Kingdom
Austin House, 11 Liberty Way
Nuneaton, Warwickshire CV11 6RZ
England
Tel: 0800 ADECUK (233285) within UK
Tel: 44 24 7635 0901 outside UK
www.a-dec.co.uk

A-dec Australia

41-43 Bowden Street
Alexandria NSW 2015 Australia
Tel: 61 (0)2 9699 4600
www.a-dec.com.au

Printed in the USA.
Copyright © 2006,
All Rights Reserved.